



PRODUCTS CATALOG

ELECTRICAL ENCLOSURES & MODULAR CABINETS



20

exmweb.com

STAINLESS STEEL HINGED WIRING TROUGHS (BOLT-ON FEET)

The 1412 CHSS stainless steel hinged cover oil and dust tight troughs are used indoors or outdoors to protect the enclosed controls from dust, dirt, oil and water splashing. The box and cover are made of high quality 16 GA (Type 304) stainless steel, with all seams continuously welded.

The opening has a flange around all sides, which increases rigidity and ensures complete contact with the poured, high quality, oil resistant seamless gasket. The door is secured by convenient 1/4 turn locks and can be opened over 180°. Internal mounting holes are provided and a wall

mounting kit is supplied. The enclosures are unpainted and brushed smooth.

**CSA Certified / UL Listed
NEMA/EEMAC 4X / IP66**

**Refer to p.734 to validate
choice of substrate for the
application**

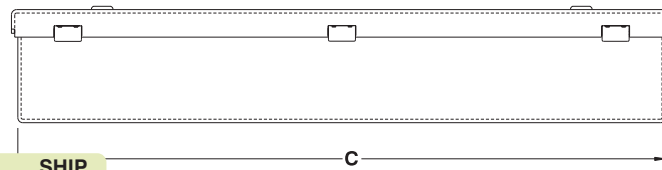
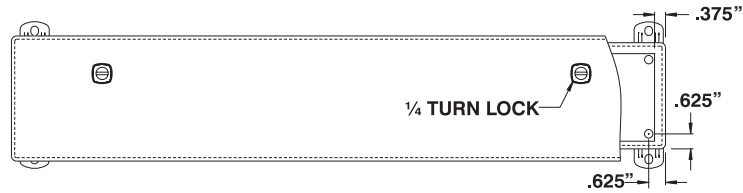
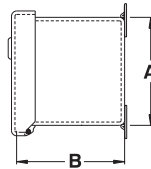

CATALOG NUMBER	DIMENSIONS			SHIP WGT LBS.
	A	B	C	
1412 CHSS020212	2.5	2.5	12	3
1412 CHSS020218	2.5	2.5	18	5
1412 CHSS020224	2.5	2.5	24	6
1412 CHSS020230	2.5	2.5	30	9
1412 CHSS020236	2.5	2.5	36	10
1412 CHSS020248	2.5	2.5	48	13
1412 CHSS020260	2.5	2.5	60	16
1412 CHSS020272	2.5	2.5	72	19
1412 CHSS040412	4	4	12	6
1412 CHSS040418	4	4	18	8
1412 CHSS040424	4	4	24	10
1412 CHSS040430	4	4	30	13
1412 CHSS040436	4	4	36	16
1412 CHSS040448	4	4	48	20
1412 CHSS040460	4	4	60	25
1412 CHSS040472	4	4	72	30
1412 CHSS060612	6	6	12	9
1412 CHSS060618	6	6	18	12
1412 CHSS060624	6	6	24	16
1412 CHSS060630	6	6	30	19
1412 CHSS060636	6	6	36	23
1412 CHSS060648	6	6	48	29
1412 CHSS060660	6	6	60	32
1412 CHSS060672	6	6	72	43
1412 CHSS080812	8	8	12	11
1412 CHSS080824	8	8	12	15
1412 CHSS080836	8	8	36	19
1412 CHSS080848	8	8	48	33
1412 CHSS080860	8	8	60	41
1412 CHSS121224	12	12	24	34
1412 CHSS121236	12	12	36	49
1412 CHSS121248	12	12	48	60
1412 CHSS121260	12	12	61	73



p.512

